

CITY OF NAPOLEON
ENGINEERING DEPARTMENT
SIGN PERMIT

(Please Print or Type)

Owner's Name Dr. Jeffrey Lauf Optometric
Address 102 E. Washington - Hahn Center
Builder Shepard Signs Address P.O. Box 21

SIGN BILLBOARD

AWNING

MARQUEE

Location of Project: 102 E. Washington

Additional Information: 1 hanging inside window - 1 painted on inside of door

Dimensions Window Sign 4' X 25' Door Sign 1' X 1 1/2' Square Feet 11 1/2'

Date 9/30/99

..... Signature of Applicant

White - Applicant
Yellow - Clerk-Treasurer
Pink - Engineering

Gold - County Auditor

Do Not Write Within Boxed Area.
For Engineering Office Use Only.

Permit No.	00459
Issued	8-30-89
By	Eldon Huber
Estimated Cost	53.00
Base Fee	10.00
Add	.92
Total Fee	10.92

..... Tel. 592-1026

Do Not Write Within Boxed Area.
For Engineering Office Use Only.

CITY OF NAPOLEON
ENGINEERING DEPARTMENT

APPLICATION for SIGN PERMIT

(Please Print or Type)

Owner's Name DR. JEFFREY LAUF OPTOMETRIST
Address 102 E WASHINGTON - HAHN CENTER
Builder SHEPARD SIGNS Address P.O. BOX 21
Permit No. 00459
Issued 8-30-89
By 54
Estimated Cost 53.00
Base Fee 10.00
Add 92
Total Fee 112.92

Tel 592.1026

SIGN BILLBOARD AWNING MARQUEE

Location of Project: 102 E WASHINGTON
HANGING INSIDE WINDOW - 1 HAHN PAINTED
ON INSIDE OF DOOR

Additional Information:

Dimensions WINDOW SIGN. 4' x 2 1/2' (10) DOOR SIGN. 1' x 1 1/2' (1 1/2) Square Feet 11 1/2
Date 8/30/89 Signature of Applicant Robert Shuman

Application Must Be Accompanied with Sketch and Description of Proposed Installation

Base Fee \$5.00 plus \$.08 Per Sq. Ft. Estimated Cost \$.00

PAID
AUG 30 1989
CITY OF NAPOLEON

Sketch of Proposed SIGN
also provide a Location Map
on back

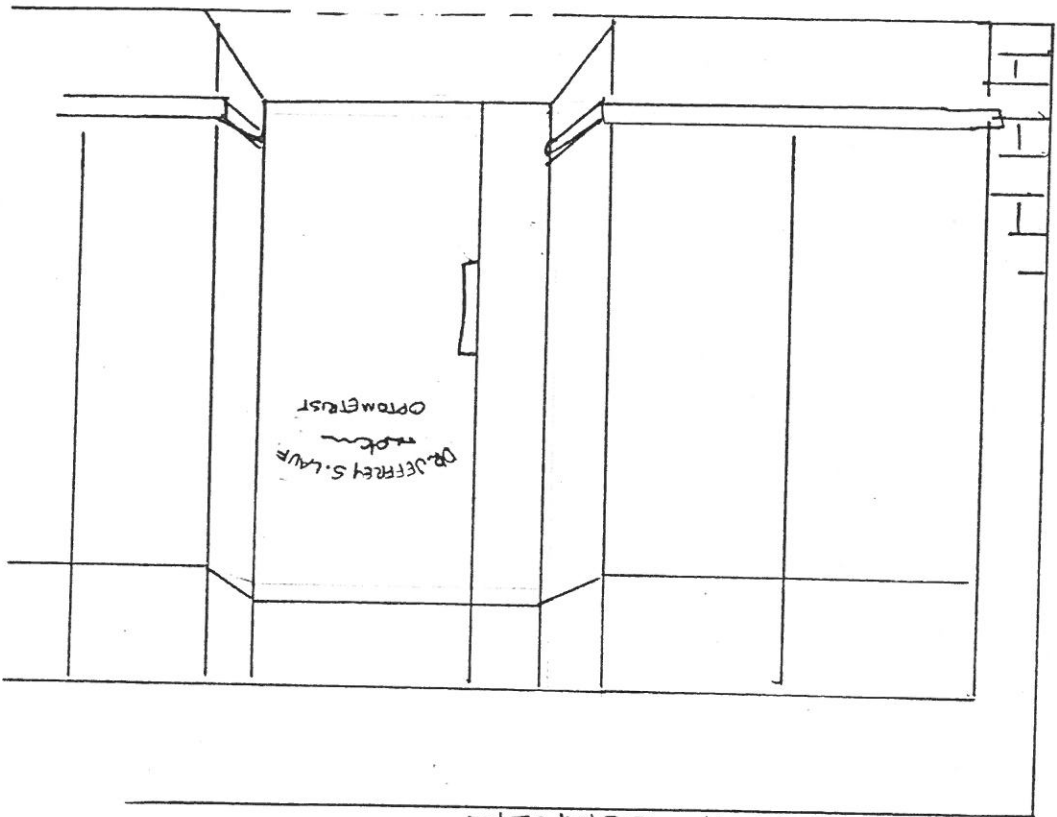

SOUTH CORNER

DOOR - 2000

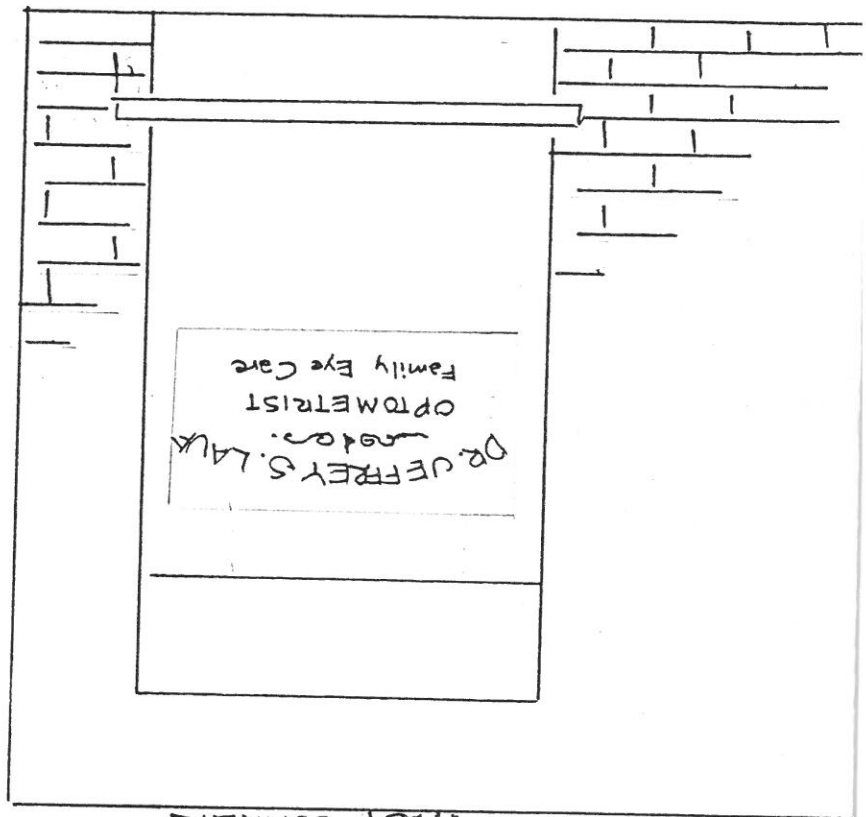

WEST CORNER

SIGN -
 PLEXIGLAS -
 HARDWARE -
 BRASS HOOKS 400
 2' x 4' - 1900
 3000
 5300
 LABOR

DR. JEFFREY S. HAVEN
OPTOMETRIST
Family Eye Care

22